

ENGLISH LATHE SCREWCUTTING EXAMPLE

TO CUT A 12 TPI THREAD

$$\frac{38}{28} \times \frac{28}{38} \times \frac{32}{100} \times \frac{100}{48} \times \frac{1}{8} = 0.0833 = 12$$

REVERSING GEARS	END DRIVE	LEADSCREW PITCH	RESULTING PITCH	T.P.I.

REFER TO SCREW THREAD CHART CH160

METRIC LATHE SCREWCUTTING EXAMPLE

TO CUT A 2,0 PITCH THREAD

$$\frac{38}{28} \times \frac{28}{38} \times \frac{32}{100} \times \frac{100}{48} \times 3 = 2,0$$

REVERSING GEARS	END DRIVE	LEADSCREW PITCH	RESULTING PITCH

REFER TO SCREW THREAD CHART CH159

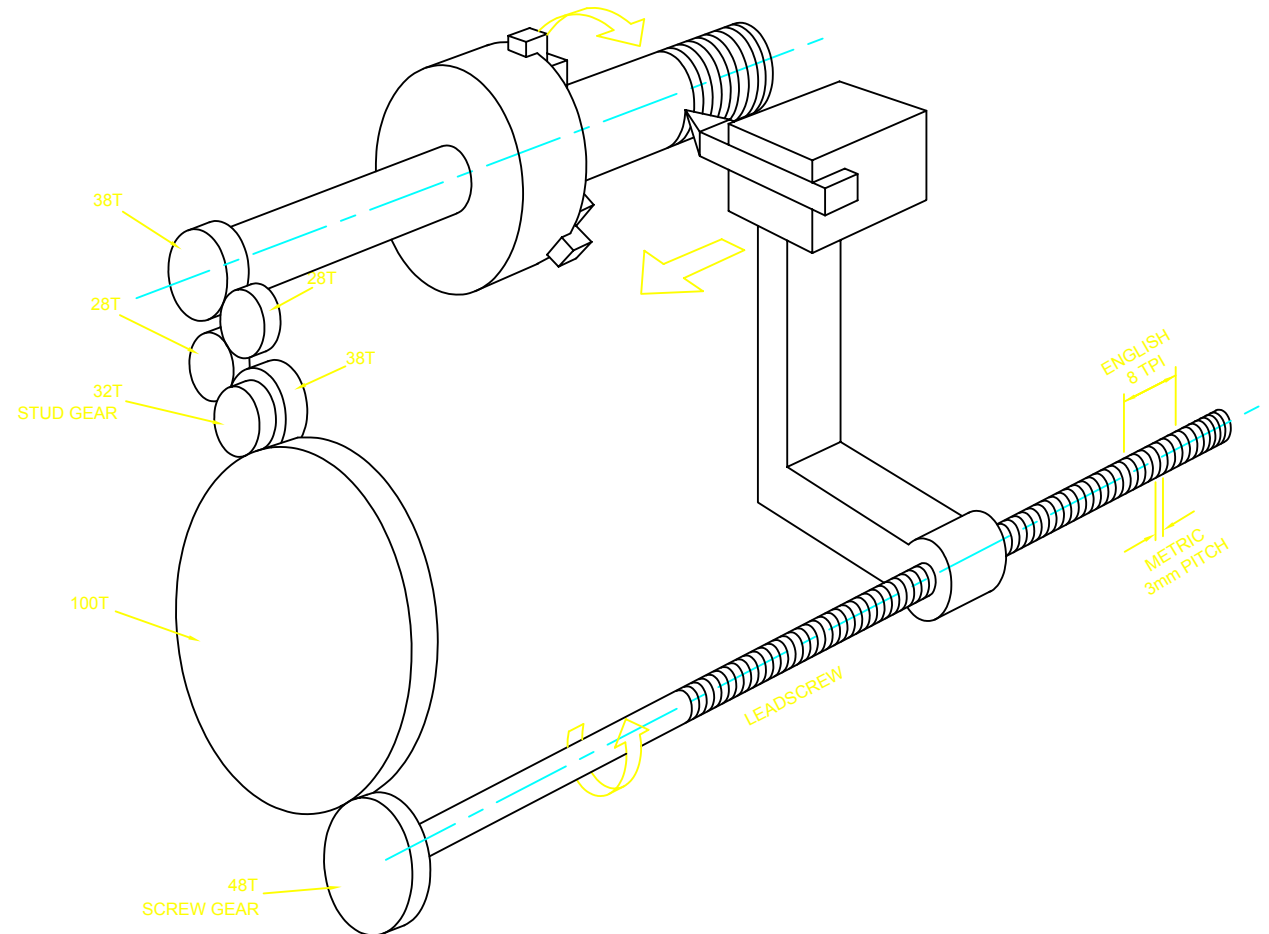

<div>DENFORD</div> <div>COMPUTERISED MACHINES AND SYSTEMS</div>	DRAWN	IV	CHECKED
	DATE	29.11.02	
	SCALE	----	
	MACHINE	TDS.1 LS & TDS 1/2 PCS	
	TITLE	SCREWCUTTING EXAMPLE	
	DWG N°.	ML105/100D	